

Walraven KSB2 Clamp (M8/M10/1/2")

(A05118)

for steel, copper, cast iron and plastic (multilayer) pipe

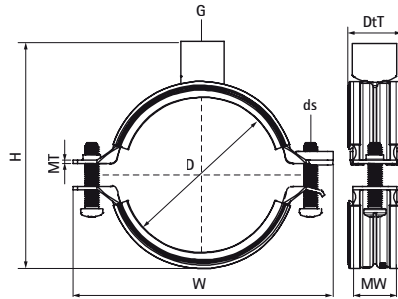

Features & benefits

- two-screw clamp with a triple connection nut
- quick closing mechanism for easy locking of the clamp with one hand
- full range from 10 to 225 mm
- the triple connection nut with M8/M10/G1/2" internal thread can be converted into a connection nut with M8/M10 internal thread and 1/2" external thread by unscrewing the sleeve
- material: steel
- zinc plated
- temperature resistance from -30 °C to +120 °C
- sound insulating lining according DIN 4109
- noise reduction according to ISO 3822-1 up to 21 dB(A)

EPD

Product Number	VVS Number	DN	Pipe Diameter Imperial	Connection Thread	Total Height	Total Width	Total Depth	Material Width	Material Thickness	Screw Size	Maximum Allowed Load Faz	Approvals
Reference letter		D	D	G	H	W	DtT	MW	MT	ds	Fa,z	
Unit description		"	"		mm	mm	mm	mm	mm		N	
33965014	018019414	DN 8	-	M8/M10/G1/2"	57	59	27	20	1.25	M6	400	EPD
33965019	018019419	DN 10	3/8	M8/M10/G1/2"	61	63	27	20	1.25	M6	400	EPD
33965023	018019423	DN 15	1/2	M8/M10/G1/2"	66	68	27	20	1.25	M6	400	EPD
33965028	018019428	DN 20	3/4	M8/M10/G1/2"	72	74	27	20	1.25	M6	400	EPD
33965035	018019435	DN 25	1	M8/M10/G1/2"	78	80	27	20	1.25	M6	400	EPD
33965039	018019439	-	-	M8/M10/G1/2"	82	84	27	20	1.25	M6	400	EPD
33965045	018019445	DN 32	1 1/4	M8/M10/G1/2"	89	91	27	20	1.25	M6	400	EPD
33965052	018019452	DN 40	1 1/2	M8/M10/G1/2"	95	97	27	20	1.25	M6	400	EPD
33965058	018019458	-	-	M8/M10/G1/2"	102	104	27	20	1.25	M6	400	EPD
33965064	018019464	DN 50	2	M8/M10/G1/2"	107	109	27	20	1.25	M6	400	EPD
33965070	018019470	-	-	M8/M10/G1/2"	115	118	27	20	1.50	M6	400	EPD
33965079	018019479	DN 65	2 1/2	M8/M10/G1/2"	122	125	27	20	1.50	M6	700	EPD
33965083	018019483	-	-	M8/M10/G1/2"	121	131	27	20	1.50	M6	700	EPD
33965091	018019491	DN 80	3	M8/M10/G1/2"	137	142	27	23	2.00	M6	700	EPD
33965105	018019505	-	-	M8/M10/G1/2"	151	155	27	23	2.00	M6	1,230	
33965115	018019515	DN 100	4	M8/M10/G1/2"	159	164	27	23	2.00	M6	1,230	EPD
33965130	018019530	-	-	M8/M10/G1/2"	176	181	27	23	2.00	M6	1,230	EPD
33965140	018019540	DN 125	5	M8/M10/G1/2"	187	191	28	23	2.00	M6	1,230	EPD
33965160	018019560	-	-	M8/M10/G1/2"	207	211	28	23	2.00	M6	1,230	EPD
33965169	018019569	DN 150	6	M8/M10/G1/2"	215	225	27	25	2.50	M8	2,390	EPD
33965180	018019580	-	-	M8/M10/G1/2"	228	234	27	25	2.50	M8	2,390	EPD
33965200	018019600	-	-	M8/M10/G1/2"	247	253	27	25	2.50	M8	2,390	EPD
33965210	018019610	-	-	M8/M10/G1/2"	259	265	27	25	2.50	M8	2,390	EPD
33965225	018019625	DN 200	8	M8/M10/G1/2"	273	279	27	25	2.50	M8	2,390	EPD