

## Walraven Heavy Duty Clamp HD500 (1") (BUP1000)

(B1019)

for steel pipes

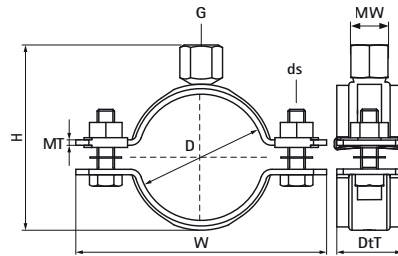

### Features & benefits

- two-part clamp with two locking bolts
- heavy design
- bolts secured with anti-loss washer
- with CO<sub>2</sub> welded connection nut
- material: steel
- surface protection:
- product is part of the Walraven BIS UltraProtect® 1000 system
- suitable for in- and outdoor applications
- stands min. 1,000 hours salt spray test (max. 5% red rust) according to ISO 9227
- also available: noise insulating lining of silicone rubber (reddish brown), heat resistant up to +200 °C (A 35 15)



Product Number	DN	Pipe Diameter Imperial	Connection Thread	Total Height	Total Width	Total Depth	Material Width	Material Thickness	Screw Size	Maximum Allowed Load Faz	Approvals
Reference letter	D	D	G	H	W	DtT	MW	MT	ds	Fa,z	
Unit description											N
33088169	-	6	G1"	199	240	38	38	4.00	M10	8,200	ITB (KOT), EPD
33088408	DN 400	16	G1"	438	487	48	48	5.00	M12	12,000	ITB (KOT), EPD