

Walraven VibraTek® MS-1X Spring Mount

(L20509)

high performance spring isolator for medium to heavy equipment

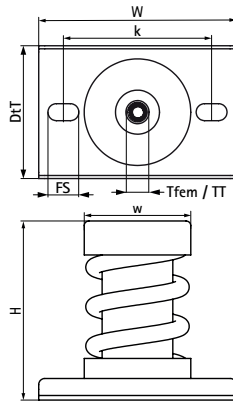

Features & benefits

- recommended for equipment with low working speeds, from 600 rpm and above
- epoxy powder-coated base, caps and springs provide increased resistance to corrosion
- flexible internal filler prevents debris and solid elements entering and damaging the spring under load
- ribs in the metal base provide increased stiffness
- slot holes facilitate positioning and anchoring to the base material
- average ratio $K_x / K_z = K_y / K_z = 0.7$
- working temperature range -90 °C till 150 °C

Product Number	VVS Number	Female Thread	Thread Type	Total Height	Total Width	Total Depth	Width	Fixing Slot	Heart To Heart Distance	Recommended Minimum Load Faz	Recommended Maximum Load Faz	Maximum Static Deflection
Reference letter		Tfem	TT	H	W	DtT	w	FS	k	N	N	mm
Unit description				mm	mm	mm	mm	mm	mm			mm
2800401250	018092112	M12	Metric	116	128	86	69	20x11	96	250	1,150	25
2800401500	018092115	M12	Metric	116	128	86	69	20x11	96	300	1,380	25
2800402000	018092120	M12	Metric	116	128	86	69	20x11	96	400	1,840	25
2800403000	018092130	M12	Metric	116	128	86	69	20x11	96	600	2,760	25
2800404000	018092140	M12	Metric	116	128	86	69	20x11	96	800	3,680	25
2800405000	018092150	M12	Metric	116	128	86	69	20x11	96	1,000	4,600	25
2800406000	018092160	M12	Metric	116	128	86	69	20x11	96	1,200	5,520	25