

Walraven IH125 / IH151 Roller and Chair

(P0480)

for steel and copper pipes

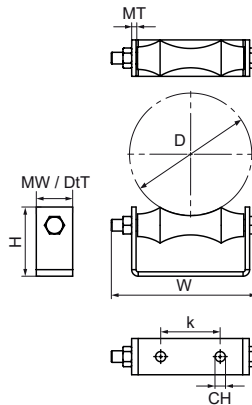
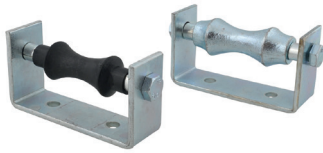

Features & benefits

- Type IH125: zinc plated, for steel pipe
- Type IH151: nylon coated, for copper pipe
- see also: IC-clamp (for conduit or cable); square nut (for threaded rod) or protective cap (to avoid damaging of protected surfaces)
- for sizes 15 NB to 50 NB see Part No. B615 3 000 on page T 05 55

Product Number	Outside Pipe Diameter	Pipe Diameter Imperial	DN	Total Height	Total Width	Total Depth	Material Width	Material Thickness	Heart To Heart Distance	Connection Hole
Reference Letter	<i>D</i>	<i>D</i>	<i>D</i>	<i>H</i>	<i>W</i>	<i>DtT</i>	<i>MW</i>	<i>MT</i>	<i>k</i>	<i>CH</i>
Unit description	mm	"		mm	mm	mm	mm	mm	mm	mm
B6103076	76		DN 65	59	132	30	30	5.00	50	11
B6103089	89	3	DN 80	60	132	40	30	5.00	50	11
B6103114	114	4	DN 100	69	152	40	40	5.00	63	11
B6103139	140	5	DN 125	84	196	50	50	6.00	76	14
B6103168	168	6	DN 150	95	196	50	50	6.00	82	14
B6103219	219	8	DN 200	97	320	69	50	10.00	115	18
B6103273	273	10	DN 250	124	389	85	50	12.00	127	22
B6103323	324		DN 300	150	424	100	50	12.00	152	22