

## Walraven Heavy Duty Clamp HD500 (M10)

(B1008)

for steel pipes

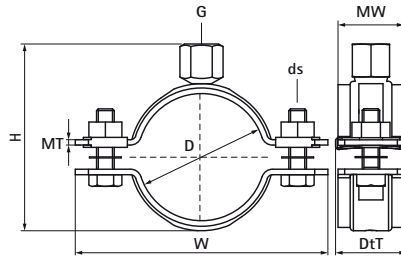

### Features & benefits

- two-part clamp with two locking bolts
- locking nut is captive, hidden in plastic holder
- heavy design
- bolts secured with anti-loss washer
- with CO<sub>2</sub> welded connection nut
- material: steel
- surface protection: product is part of the Walraven BIS UltraProtect® 1000 system
- suitable for in- and outdoor applications
- stands min. 1,000 hours salt spray test (max. 5% red rust) according to ISO 9227
- FM & VdS certified for sprinkler installations



Product Number	DN	Pipe Diameter Imperial	Connection Thread	Total Height	Total Width	Total Depth	Material Width	Material Thickness	Screw Size	Maximum Allowed Load Faz	Approvals
Reference letter	D	D	G	H	W	DtT	MW	MT	ds	Fa,z	
Unit description	"			mm	mm	mm	mm	mm		N	
33018030	DN 20	¾	M10	49	85	32	30	2.50	M8	2,100	FM, VdS, CE, ETA, EPD
33018036	DN 25	1	M10	55	91	32	30	2.50	M8	2,100	FM, VdS, CE, ETA, EPD
33018045	DN 32	1¼	M10	64	102	32	30	2.50	M8	2,100	FM, VdS, CE, ETA, EPD
33018052	DN 40	1½	M10	71	109	32	30	2.50	M8	2,100	FM, VdS, CE, ETA, EPD
33018065	DN 50	2	M10	84	121	32	30	2.50	M8	2,100	FM, VdS, CE, ETA, EPD