

## Walraven Pipe Clamp 4000 (M8) (ZP)

(B3510)

for plastic pipes

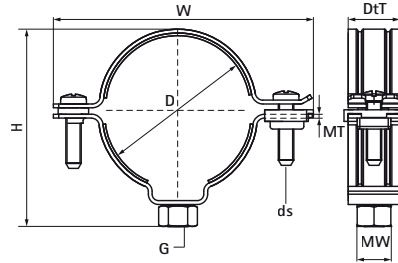

### Features & benefits

- two-screw clamp
- with quick locking system; will not open during installation
- with removable spacer washers, making the clamp suitable for either sliding or anchoring
- inside clamp diameter larger than outside pipe diameter for expansion or contraction of the pipe
- inside profile to protect pipes from damage
- material: steel 1.0332
- zinc plated

## EPD

Product Number	RSK Number	DN	Connection Thread	Total Height	Total Width	Total Depth	Material Width	Material Thickness	Screw Size	Maximum Allowed Load Faz	Approvals
Reference letter		D	G	H	W	DtT	MW	MT	ds	Fa,z	
Unit description				mm	mm	mm	mm	mm		N	
4443032	3800200	DN 25	M8	54	76	23	20	1.50	M6	910	EPD
4443040	3800201	DN 32	M8	61	84	23	20	1.50	M6	910	EPD
4443050	3800202	DN 40	M8	71	94	23	20	1.50	M6	910	EPD
4443056		DN 50	M8	77	100	23	20	1.50	M6	910	EPD
4443063	3800203	DN 50	M8	84	107	23	20	1.50	M6	910	EPD
4443070		DN 65	M8	91	114	23	20	1.50	M6	910	EPD
4443075	3800204	DN 70	M8	96	119	23	20	1.50	M6	910	EPD
4443080		DN 70	M8	101	124	23	20	1.50	M6	910	EPD
4443090	3800205	DN 80	M8	111	134	23	20	1.50	M6	910	EPD
4443100		DN 80	M8	121	144	23	20	1.50	M6	910	EPD
4443110	3800206	DN 100	M8	132	158	26	23	2.00	M6	2,200	
4443125		DN 125	M8	148	173	26	23	2.00	M6	2,200	EPD
4443160	3820831	DN 150	M8	183	208	26	23	2.00	M6	2,200	EPD
4443200		DN 200	M8	224	248	26	23	2.00	M6	2,200	