

## Walraven RapidRail® Hammerfix

(G3050)

pre-assembled thread adapter to connect pipe clamps to rails

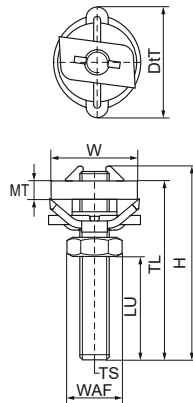

### Features & benefits

- slide nut with stud bolt, washer and Walraven RapidRail® spring
- suitable for rails 27x18, 30x15, 30x20, 30x30, 30x45 and 38x40
- ready-to-use pre-assembled for a quick fixing, and retains assembly in place before final tightening
- material: metal parts made of steel 1.0332; spring(s) made of POM (polyoxymethylene), green
- zinc plated

Product Number	RSK Number	For Rail Type	Thread Size	Thread Length	Usable Length	Material Thickness	Width Across Flats	Torque Moment For Installation	Maximum Allowed Load Faz	Total Height	Total Width	Total Depth
Reference letter			TS	TL	LU	MT	WAF	T inst.	Fo,z	H	W	DtT
Unit description				mm	mm	mm	mm	Nm	N	mm	mm	mm
6523002	3821229	27x18, 30x15, 30x20, 30x30, 38x40	M10	25	6.25	5.00	17	10	2,900	29.6	27.61	34.57
6523003	3821230	27x18, 30x15, 30x20, 30x30, 38x40	M10	30	11.25	5.00	17	10	2,900	34.6	27.61	35.57
6523004	3820160	27x18, 30x15, 30x20, 30x30, 38x40	M10	40	21.25	5.00	17	10	2,900	44.6	27.61	34.57
6523005	3821231	27x18, 30x15, 30x20, 30x30, 38x40	M10	50	31.25	5.00	17	10	2,900	54.6	27.61	34.57
6523006	3821232	27x18, 30x15, 30x20, 30x30, 38x40	M10	60	41.25	5.00	17	10	2,900	64.6	27.61	34.57
6523008	3820162	27x18, 30x15, 30x20, 30x30, 38x40	M10	80	61.25	5.00	17	10	2,900	84.6	27.61	34.57
6523010	3821235	27x18, 30x15, 30x20, 30x30, 38x40	M10	100	81.25	5.00	17	10	2,900	104.6	27.61	34.57
6523016	3821260	27x18, 30x15, 30x20, 30x30, 38x40	M10	160	141.25	5.00	17	10	2,900	141.25	27.61	34.57
6523602		27x18, 30x15, 30x20, 30x30, 38x40	M6	20	5.25	4.00	10	7.5	2,000	24	27.61	34.57
6523603		27x18, 30x15, 30x20, 30x30, 38x40	M6	30	15.25	4.00	10	7.5	2,000	34	27.61	34.57
6523802	3820163	27x18, 30x15, 30x20, 30x30, 38x40	M8	25	7.75	5.00	13	10	2,700	29	27.61	34.57
6523803	3820166	27x18, 30x15, 30x20, 30x30, 38x40	M8	30	12.75	5.00	13	10	2,700	34	27.61	34.57
6523804	3820681	27x18, 30x15, 30x20, 30x30, 38x40	M8	40	22.75	5.00	13	10	2,700	44	27.61	34.57
6523805	3820682	27x18, 30x15, 30x20, 30x30, 38x40	M8	50	32.75	5.00	13	10	2,700	54	27.61	34.57
6523806	3820683	27x18, 30x15, 30x20, 30x30, 38x40	M8	60	42.75	5.00	13	10	2,700	64	27.61	34.57
6523807	3821225	27x18, 30x15, 30x20, 30x30, 38x40	M8	70	52.75	5.00	13	10	2,700	74	27.61	34.57
6523808	3820684	27x18, 30x15, 30x20, 30x30, 38x40	M8	80	62.75	5.00	13	10	2,700	84	27.61	34.57
6523810	3820167	27x18, 30x15, 30x20, 30x30, 38x40	M8	100	82.75	5.00	13	10	2,700	104	27.61	34.57
6523812	3820686	27x18, 30x15, 30x20, 30x30, 38x40	M8	120	102.75	5.00	13	10	2,700	124	27.61	34.57
6523815	3821227	27x18, 30x15, 30x20, 30x30, 38x40	M8	150	132.75	5.00	13	10	2,700	154	27.61	34.57
6523818	3820687	27x18, 30x15, 30x20, 30x30, 38x40	M8	180	162.75	5.00	13	10	2,700	184	27.61	34.57

## Walraven RapidRail® Hammerfix

(G3050)

pre-assembled thread adapter to connect pipe clamps to rails

Product Number	RSK Number	For Rail Type	Thread Size	Thread Length	Usable Length	Material Thickness	Width Across Flats	Torque Moment For Installation	Maximum Allowed Load Faz	Total Height	Total Width	Total Depth
<i>Reference letter</i>			<i>TS</i>	<i>TL</i>	<i>LU</i>	<i>MT</i>	<i>WAF</i>	<i>Tinst.</i>	<i>Fa,z</i>	<i>H</i>	<i>W</i>	<i>DiT</i>
<i>Unit description</i>				<i>mm</i>	<i>mm</i>	<i>mm</i>	<i>mm</i>	<i>Nm</i>	<i>N</i>	<i>mm</i>	<i>mm</i>	<i>mm</i>
6523820	3820168	27x18, 30x15, 30x20, 30x30, 38x40	M8	200	182.75	5.00	13	10	2,700	204	27.61	34.57