

## Walraven RapidStrut® Hammerfix 'U' G2 (BUP1000)

(H2459)

for quick connection of clamps to the rail

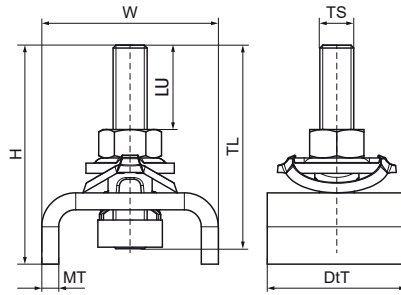

### Features & benefits

- slide nut with stud bolt, U-shaped washer and Walraven RapidStrut® spring
- U-shaped for extra stability
- ready-to-use pre-assembled for a quick fixing, and retains assembly in place before final tightening
- visual guide to check the position of the slide nut
- material: metal parts made of steel 1.0332; spring(s) made of POM (polyoxymethylene), green
- product is part of the Walraven UltraProtect® 1000 system
- suitable for in- and outdoor applications
- stands min. 1,000 hours salt spray test (max. 5% red rust) according to ISO 9227

Product Number	RSK Number	For Rail Type	Thread Size	Thread Length	Usable Length	Material Thickness	Torque Moment For Installation	Maximum Allowed Load Fax	Maximum Allowed Load Faz	Total Height	Total Width	Total Depth
<i>Reference letter</i>			<i>TS</i>	<i>TL</i>	<i>LU</i>	<i>MT</i>	<i>T inst.</i>	<i>Fa,x</i>	<i>Fa,z</i>	<i>H</i>	<i>W</i>	<i>DtT</i>
<i>Unit description</i>				<i>mm</i>	<i>mm</i>	<i>mm</i>	<i>Nm</i>	<i>N</i>	<i>N</i>	<i>mm</i>	<i>mm</i>	<i>mm</i>
665285006	4436220	41x21, 41x41, 41x51, 41x62, 41x82	M10	60	30	5.00	15	1,250	10,000	65	52	41