

Walraven Wall Plate CO₂ Welded

(K1512)

fixing to wall or ceiling

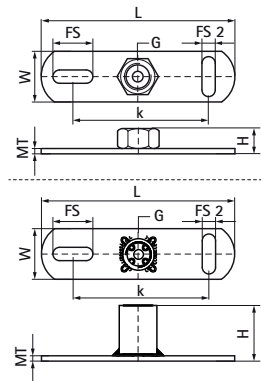

Features & benefits

- fixings to wall, ceiling or floor (tension and bending loads allowed)
- slots at 90° to each other to simplify fixing
- with CO₂ welded connection nut
- material: steel
- zinc plated

Product Number	Connection Thread	Total Length	Total Width	Total Height	Material Thickness	Fixing Slot	Fixing Slot 2	Heart To Heart Distance	Maximum Allowed Load Faz
<i>Reference letter</i>	<i>G</i>	<i>L</i>	<i>W</i>	<i>H</i>	<i>MT</i>	<i>FS</i>	<i>FS 2</i>	<i>k</i>	<i>Fa,z</i>
<i>Unit description</i>		<i>mm</i>	<i>mm</i>	<i>mm</i>	<i>mm</i>	<i>mm</i>	<i>mm</i>	<i>mm</i>	<i>N</i>
6719021	G1/2"	145	38	22	4.00	30x11	25x11	100	4,000
6719027	G3/4"	145	38	27	4.00	30x11	25x11	100	5,000
6719033	G1"	145	38	27	4.00	30x11	25x11	100	5,500
6719012	M12	145	38	17	4.00	30x11	25x11	100	6,000
6719016	M16	145	38	20	4.00	30x11	25x11	100	6,000