

Walraven Bifix® 300 Stainless Steel (M8)

(M1005)

for stainless steel and plastic pipes

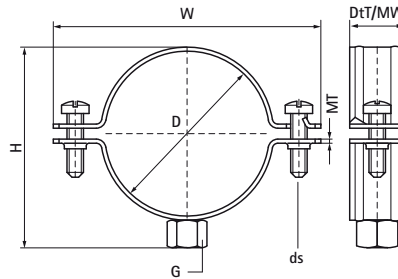

Features & benefits

- two-screw clamp
- with quick locking system
- material: stainless steel 1.4404 (AISI 316L)



Product Number	RSK Number	DN	Pipe Diameter Imperial	Connection Thread	Total Height	Total Width	Total Depth	Material Width	Material Thickness	Screw Size	Maximum Allowed Load Faz	Approvals
Reference letter		D	D	G	H	W	DtT	MW	MT	ds	F _{0,z}	
Unit description			"		mm	mm	mm	mm	mm		N	
3017017	3800130	DN 10	3/8	M8	31	56	20	20	1.25	M6	1,000	RAL-GZ 655/B, ITB (KOT), EPD
3017022	3800131	DN 15	1/2	M8	33	58	20	20	1.25	M6	1,000	RAL-GZ 655/B, ITB (KOT), EPD
3017030	3800208	DN 20	3/4	M8	39	64	20	20	1.25	M6	1,000	RAL-GZ 655/B, ITB (KOT), EPD
3017034	3800209	DN 25	1	M8	47	72	20	20	1.25	M6	1,000	RAL-GZ 655/B, ITB (KOT), EPD
3017042	3800210	DN 32	1 1/4	M8	54	80	20	20	1.25	M6	1,000	RAL-GZ 655/B, ITB (KOT), EPD
3017051	3800211	DN 40	1 1/2	M8	62	87	20	20	1.25	M6	1,000	RAL-GZ 655/B, ITB (KOT), EPD
3017060	3800212	-	-	M8	71	96	20	20	1.25	M6	1,000	RAL-GZ 655/B, ITB (KOT), EPD
3017076	3800213	-	-	M8	86	109	20	20	2.00	M6	1,500	RAL-GZ 655/B, ITB (KOT), EPD
3017089	3800214	DN 80	3	M8	101	124	20	20	2.00	M6	1,500	RAL-GZ 655/B, ITB (KOT), EPD
3017118	3800215	DN 100	4	M8	131	154	20	20	2.50	M6	1,900	RAL-GZ 655/B, ITB (KOT), EPD