

Walraven Square Slide Nut

(G3020)

threaded plate to connect components to rails

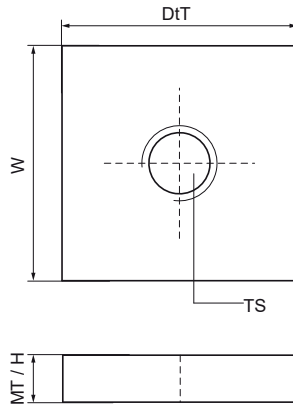
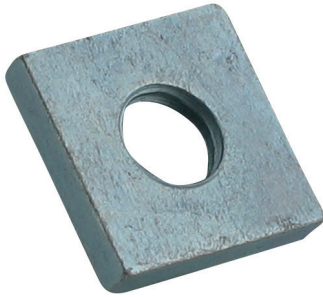

Features & benefits

- suitable for rails 27x18, 30x15, 30x20, 30x30, 30x45
- square shape for extra security, due to its geometry needs to get installed from the side into the profile
- material: steel 1.0332
- zinc plated

| Product Number | For Rail Type | Thread Size | Material Thickness | Total Height | Total Width | Total Depth |
|-------------------------|----------------------------|-------------|--------------------|--------------|-------------|-------------|
| <i>Reference Letter</i> | | <i>TS</i> | <i>MT</i> | <i>H</i> | <i>W</i> | <i>DtT</i> |
| <i>Unit description</i> | | | <i>mm</i> | <i>mm</i> | <i>mm</i> | <i>mm</i> |
| 6519910 | 30x15, 30x20, 30x30, 38x40 | M6 | 4.00 | 4 | 25 | 25 |
| 6519911 | 30x15, 30x20, 30x30, 38x40 | M8 | 5.00 | 5 | 25 | 25 |
| 6519912 | 30x15, 30x20, 30x30, 38x40 | M10 | 5.00 | 5 | 25 | 25 |
| 6519913 | 30x15, 30x20, 30x30, 38x40 | M12 | 5.00 | 5 | 25 | 25 |