

Walraven RapidRail® Ball Swivel Hanger

(G3060)

fixing to Walraven RapidRail®

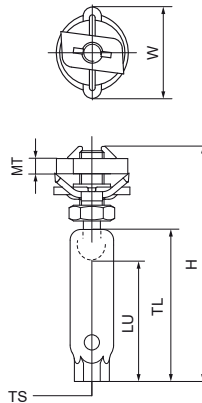

Features & benefits

- slide nut with ball swivel hanger, washer and Walraven RapidRail® spring
- recommended to accommodate pipe expansions for metal pipes up to DN 50, plastic pipes up to DN 100
- suitable for rails 27x18, 30x15, 30x20, 30x30, 30x45
- ready-to-use pre-assembled for a quick fixing, and retains assembly in place before final tightening
- with inspection hole to check screw-in depth (attention: when the threaded rod is screwed-in too deep, the ball swivel is blocked)
- screw-in depth is continuously variable (see LU)
- material: metal parts made of steel 1.0332; spring(s) made of POM (polyoxymethylene), green zinc plated
- For detailed technical information about our RAL marked products, please see the RAL datasheet in our web catalogue
- Please note. Always use 2 ball swivel hangers and secure by additional hexagon nut (see application picture)
- The maximum length change that can be dealt with, depends on the fixing distance (ceiling - pipe) The height difference that occurs as a result, needs to be taken into consideration.
- To be used in combination with Walraven Ball Swivel Hangers.

| Product Number | For Rail Type | Thread Size | Thread Length | Usable Length | Material Thickness | Maximum Allowed Load Fax | Maximum Allowed Load Faz | Total Height | Total Width | Total Depth |
|------------------|-----------------------------------|-------------|---------------|---------------|--------------------|--------------------------|--------------------------|--------------|-------------|-------------|
| Reference Letter | | TS | TL | LU | MT | Fa,x | Fa,z | H | W | DtT |
| Unit description | | | mm | mm | mm | N | N | mm | mm | mm |
| 6520100 | 27x18, 30x15, 30x20, 30x30, 38x40 | M8 | 15 | 12.5 | 5.00 | 182 | 2,000 | 49 | 29 | 29 |
| 6520110 | 27x18, 30x15, 30x20, 30x30, 38x40 | M10 | 15 | 9.5 | 5.00 | 226 | 2,000 | 49 | 29 | 29 |
| 6520200 | 27x18, 30x15, 30x20, 30x30, 38x40 | M8 | 37.5 | 32 | 5.00 | 182 | 2,000 | 74 | 29 | 29 |
| 6520210 | 27x18, 30x15, 30x20, 30x30, 38x40 | M10 | 37.5 | 32 | 5.00 | 226 | 2,000 | 74 | 29 | 29 |