

Walraven Wall Plate CO₂ Welded (BUP1000)

(K1509)

fixing to wall or ceiling

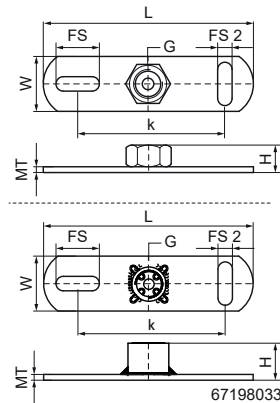

Features & benefits

- fixings to wall, ceiling or floor (tension and bending loads allowed)
- slots at 90° to each other to simplify fixing
- with CO₂ welded connection nut
- material: steel
- product is part of the Walraven UltraProtect® 1000 system
- suitable for in- and outdoor applications
- stands min. 1,000 hours salt spray test (max. 5% red rust) according to ISO 9227

Product Number	Connection Thread	Total Length	Total Width	Total Height	Material Thickness	Fixing Slot	Fixing Slot 2	Heart To Heart Distance	Maximum Allowed Load Faz
Reference Letter	G	L	W	H	MT	FS	FS 2	k	F _{0,z}
Unit description		mm	mm	mm	mm	mm	mm	mm	N
67198016	M16	145	38	20	4.00	30x11	25x11	100	6,000
67198021	G1/2"	145	38	22	4.00	30x11	25x11	100	4,000
67198033	G1"	145	38	27	4.00	30x11	25x11	100	5,500