

Walraven Hexagon Head Bolt

(K4520)

for threaded connections

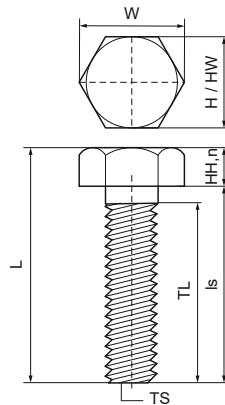
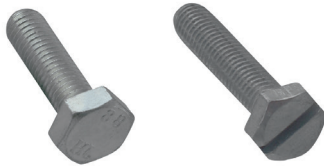

Features & benefits

- according to DIN 933
- material: steel, strength class 8.8
- zinc plated

Product Number	Thread Size	Screw Length	Thread Length	Head Shape	Nominal Head Height	Head Width	Key Driver Size	Total Height	Total Width	Total Length
<i>Reference Letter</i>	<i>TS</i>	<i>ls</i>	<i>TL</i>		<i>HH,n</i>	<i>HW</i>	<i>Drive</i>	<i>H</i>	<i>W</i>	<i>L</i>
<i>Unit description</i>		<i>mm</i>	<i>mm</i>		<i>mm</i>	<i>mm</i>		<i>mm</i>	<i>mm</i>	<i>mm</i>
6143620	M6	20	17	Hexagon Head	4	10	WAF10 + slot	10	12	24
6143630	M6	30	27	Hexagon Head	4	10	WAF10 + slot	10	12	34
6143816	M8	16	12.25	Hexagon Head	5.3	13	WAF13	13	15	21
6143820	M8	20	16.25	Hexagon Head	5.3	13	WAF13	13	15	25
6143825	M8	25	21.25	Hexagon Head	5.3	13	WAF13	13	15	30
6143830	M8	30	26.25	Hexagon Head	5.3	13	WAF13	13	15	35
6143835	M8	35	31.25	Hexagon Head	5.3	13	WAF13	13	15	40
6143840	M8	40	36.25	Hexagon Head	5.3	13	WAF13	13	15	45
6143860	M8	60	56.25	Hexagon Head	5.3	13	WAF13	13	15	65
6143880	M8	80	76.25	Hexagon Head	5.3	13	WAF13	13	15	85
6143920	M10	20	15.5	Hexagon Head	6.4	17	WAF17	17	20	26
6143925	M10	25	20.5	Hexagon Head	6.4	17	WAF17	17	20	31
6143930	M10	30	25.5	Hexagon Head	6.4	17	WAF17	17	20	36
6143935	M10	35	30.5	Hexagon Head	6.4	17	WAF17	17	20	41
6143940	M10	40	35.5	Hexagon Head	6.4	17	WAF17	17	20	46
6143950	M10	50	45.5	Hexagon Head	6.4	17	WAF17	17	20	56
6143960	M10	60	55.5	Hexagon Head	6.4	17	WAF17	17	20	66
6143980	M10	80	75.5	Hexagon Head	6.4	17	WAF17	17	20	86
6143990	M10	90	85.5	Hexagon Head	6.4	17	WAF17	17	20	96
6144030	M12	30	24.75	Hexagon Head	7.5	19	WAF19	19	22	38
6144050	M12	50	44.75	Hexagon Head	7.5	19	WAF19	19	22	58
6143892	M8	120	116.25	Hexagon Head	5.3	13	WAF13	13	15	125
6143850	M8	50	46.25	Hexagon Head	5.3	13	WAF13	13	15	55
6143891	M8	100	96.25	Hexagon Head	5.3	13	WAF13	13	15	105
6143894	M8	140	136.25	Hexagon Head	5.3	13	WAF13	13	15	145
6144040	M12	40	34.75	Hexagon Head	7.5	19	WAF19	19	22	48
6144640	M16	40	34	Hexagon Head	10	24	WAF24	24	28	50