

Walraven RapidStrut® Stainless Steel Slide Nut with Tabs

(M5208)

to connect construction parts to the rail

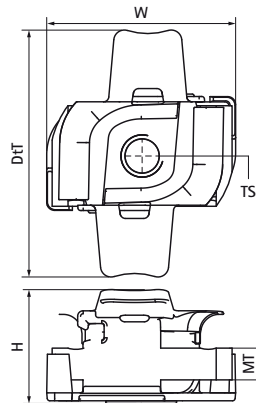

Features & benefits

- slide nut with plastic 'tabs'
- for all types of Walraven RapidStrut® Channel
- for tight fixing of accessories (e.g. connectors) on rail
- with plastic tabs which simplifies inserting and positioning
- material: slide nut made of stainless steel 1.4401 (AISI 316); 'wings' made of PP (polypropylene), blue
- Tested values in combination with Walraven RapidStrut® Channel 41x41x2.5mm.



Product Number	For Rail Type	Thread Size	Material Thickness	Torque Moment For Installation	Maximum Allowed Load Fax	Maximum Allowed Load Faz	Total Height	Total Width	Total Depth
Reference Letter		TS	MT	T _{inst.}	F _{a,x}	F _{a,z}	H	W	D _T
Unit description			mm	Nm	N	N	mm	mm	mm
651867008	41x21, 41x41, 41x51, 41x62, 41x82	M8	6.00	25	2,200	4,500	21.28	35.7	47.13
651867010	41x21, 41x41, 41x51, 41x62, 41x82	M10	8.00	40	2,550	5,000	21.28	35.7	47.13
651867006	41x21, 41x41	M6	6.00	7	950	2,660	21.28	35.7	47.13
651867012	41x21, 41x41	M12	9.00	50	2,950	5,000	21.28	35.7	47.13