

## Walraven IH125 / IH151 Roller and Chair

(P0480)

for steel and copper pipes

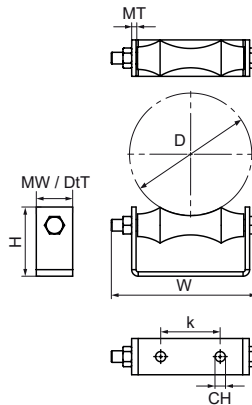
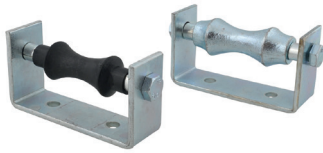

### Features & benefits

- Type IH125: zinc plated, for steel pipe
- Type IH151: nylon coated, for copper pipe
- see also: IC-clamp (for conduit or cable); square nut (for threaded rod) or protective cap (to avoid damaging of protected surfaces)
- for sizes 15 NB to 50 NB see Part No. B615 3 000 on page T 05 55

Product Number	Outside Pipe Diameter	Pipe Diameter Imperial	DN	Total Height	Total Width	Total Depth	Material Width	Material Thickness	Heart To Heart Distance	Connection Hole
Reference Letter	<i>D</i>	<i>D</i>	<i>D</i>	<i>H</i>	<i>W</i>	<i>DtT</i>	<i>MW</i>	<i>MT</i>	<i>k</i>	<i>CH</i>
Unit description	mm	"		mm	mm	mm	mm	mm	mm	mm
B6103089	89	3	DN 80	60	132	40	30	5.00	50	11
B6103114	114	4	DN 100	69	152	40	40	5.00	63	11
B6103168	168	6	DN 150	95	196	50	50	6.00	82	14
B6103219	219	8	DN 200	97	320	69	50	10.00	115	18
B6103323	324		DN 300	150	424	100	50	12.00	152	22