

Walraven Duplo KS

(C1055)

for heating pipes

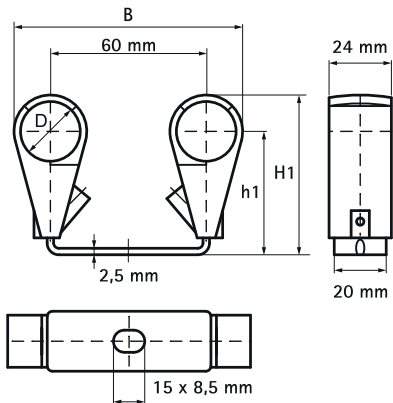

Features & benefits

- two clamps on connection bracket
- clamps can be repositioned when open or closed - only fixed when finally secured
- plastic clamp prevents noises which arise from expansion or contraction of the pipe
- adjustable distance between pipe and wall
- locking screw connected to band, which makes it impossible to lose screw
- material: connection bracket made of steel; connector made of PP (polypropylene)
- fire class B2
- recyclable, resistant to UV and ageing
- temperature resistance from approx. -30 °C to approx. +90 °C (constant); short to approx. +110 °C

Product Number	Outside Pipe Diameter	Total Width x Total Height x Total Depth	Maximum Allowed Load Fax
Reference letter	D	W x H x DtT	Fa,x
Unit description	(mm)	(mm) x (mm) x (mm)	(N)
3225015	15	82 x 69 x 24	130
3225022	22	89 x 76 x 24	130