

Walraven Expansion Joint

(E1015)

fixing with sliding assemblies

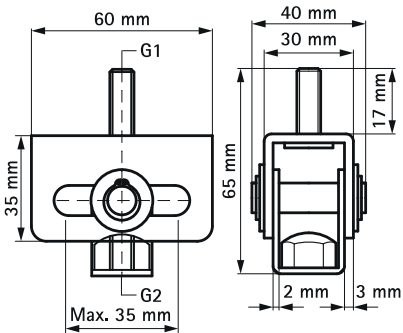

Features & benefits

- for accommodation of pipe thermal expansion or contraction
- low space requirement, can only be used for ceiling mounting (hanging)
- economical solution when low expansion
- compatible with all Walraven rail systems
- material: steel
- zinc plated

Product Number	Connection Thread	Connection Thread 2	Total Width x Total Height x Total Depth	Slide Distance	Thread Length	Thread Size	Maximum Allowed Load Faz
Reference letter	G	G2	W x H x DtT	Ls	TL	TS	Fa,z
Unit description			mm x mm x mm	mm	mm		N
6653310	M8/M10	M10	0 x 48 x 60	35	17	M10	1,500