

Walraven Adjustable Support (BUP1000)

(H1253)

for suspensions and bracing

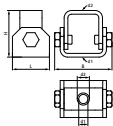
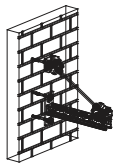

Features & benefits

- especially for angled installations with bracings
- suitable for fixing to walls or fixing rails
- adjustable angle up to 90°
- with two holes Ø13 mm
- material: steel
- product is part of the Walraven Walraven UltraProtect® 1000 system
- suitable for in- and outdoor applications
- stands min. 1,000 hours salt spray test (max. 5% red rust) according to ISO 9227

| Product Number | Total Width x Total Height x Total Length | Material Thickness | Width | Maximum Allowed Load Faz |
|------------------|---|--------------------|-------|--------------------------|
| Reference letter | W x H x L | MT | w | Fa,z |
| Unit description | (mm) x (mm) x (mm) | (mm) | (mm) | (N) |
| 66588818 | 50 x 63 x 77.50 | 5 | 50 | 5000 |