

Walraven WGB-M Aerated Concrete Anchor

(L0382)

for soft substrate

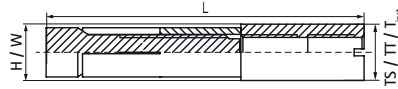

Features & benefits

- internal thread connection allows flexible distance from the anchor to the fixture
- load can be applied immediately after installation
- installation does not require drilling
- four-way expansion provides high permissible loads, even in tensile areas of roofs and ceilings
- high load safety due to undercutting expansion
- fire resistance class R30-R120 for design of anchorages under exposure to fire
- with VdS-approval – certificate number G 4980083 for applications with stationary fire extinguishing systems
- material: steel



Product Number	Thread Size	Thread Type	Total Width x Total Height x Total Length	Minimum Screw Depth	Minimum Substrate Thickness	Torque Moment For Installation
Reference letter	TS	TT	W x H x L	ls,min	hmin	T inst.
Unit description			mm x mm x mm	mm	mm	Nm
6103510	M10	Metric	16 x 16 x 92	10	175	8
6103512	M12	Metric	16 x 16 x 92	12	175	8