

Walraven WGB-M Setting Tool

(L0383)

for installation of WGB-M

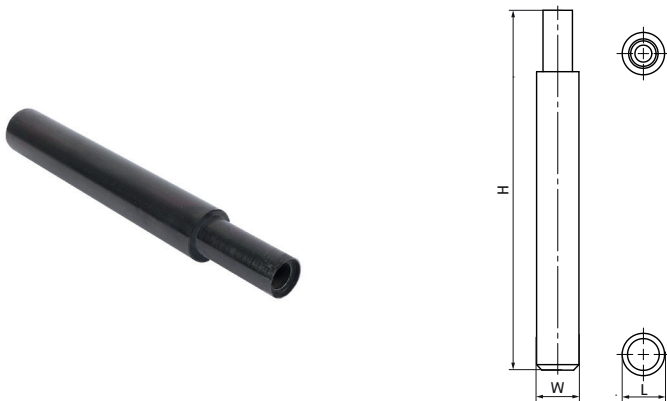

Features & benefits

- for use with WGB-M M10 or M12 aerated concrete anchors
- solid metal construction ensures high durability and many years of service

Product Number		For Thread Size	Total Width x Total Height x Total Length	
Reference letter	fts		W x H x L	
Unit description			mm x mm x mm	
6902511		M10/M12	18 x 130 x 18	