

Walraven Bifix® 300 Stainless Steel (M10)

(M1006)

for stainless steel and plastic pipes

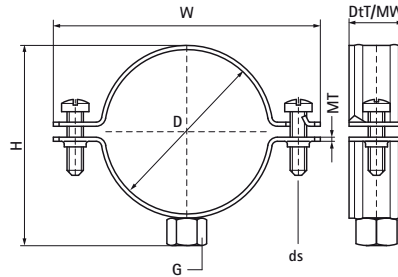

Features & benefits

- two-screw clamp
- with quick locking system
- material: stainless steel 1.4404 (AISI 316L)



Product Number	Outside Pipe Diameter	Connection Thread	Total Width x Total Height x Total Depth	Material Width x Material Thickness	Screw Size	Maximum Allowed Load Faz
Reference letter	D	G	W x H x DtT	MW x MT	ds	Fa,z
Unit description	(mm)		(mm) x (mm) x (mm)	(mm) x (mm)		(N)
3027068	62 - 68	M10	102 x 80 x 20	20 x 1.25	M6	1500
3027076	72 - 76	M10	109 x 87 x 20	20 x 2	M6	1500
3027085	79 - 85	M10	118 x 97 x 20	20 x 2	M6	1500
3027089	85 - 89	M10	124 x 102 x 20	20 x 2	M6	1500
3027105	100 - 105	M10	139 x 117 x 20	20 x 2	M6	1500
3027111	106 - 111	M10	146 x 124 x 20	20 x 2.50	M6	1900
3027118	110 - 118	M10	154 x 132 x 20	20 x 2.50	M6	1900
3027127	122 - 127	M10	163 x 140 x 20	20 x 2.50	M6	1900
3027134	129 - 134	M10	170 x 148 x 20	20 x 2.50	M6	1900
3027144	139 - 144	M10	179 x 157 x 20	20 x 2.50	M6	1900
3027155	150 - 155	M10	192 x 172 x 20	20 x 2.50	M6	1900
3027162	157 - 162	M10	196 x 174 x 20	20 x 2.50	M6	1900
3027169	164 - 169	M10	204 x 182 x 20	20 x 2.50	M6	1900
3027200	193 - 200	M10	256 x 216 x 25	20 x 2.50	M8	1900
3027219	212 - 219	M10	273 x 233 x 25	25 x 2.50	M8	1900