

# Walraven RapidRail® Stainless Steel Wall Plate

(M2710)

fixing to wall, floor or ceiling

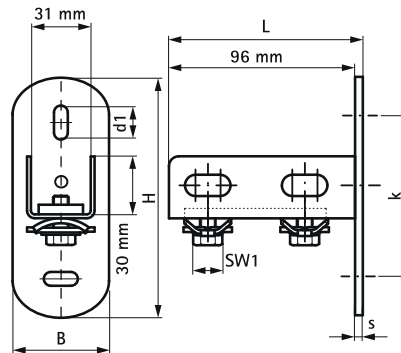

## Features & benefits

- flexible base plate for rails
- for fixing to wall, floor or ceiling
- rail can be fixed with slot downwards or sideways
- suitable for rail WM1, 15, 2
- with pre-assembled Walraven RapidRail® Sliding nut(s) for a quick fixing, and retains assembly in place before final tightening
- material: stainless steel 1.4401/1.4404 (A4) - EN10088, AISI 316/316L; spring(s) made of of POM (polyoxymethylene), blue (according to RAL 5015)

Product Number	Total Width x Total Height x Total Length	Width	Height	Length	Heart To Heart Distance	Anchoring Slot	Material Thickness	Material Thickness 2	Maximum Allowed Load Faz
Reference letter	W x H x L	w	h	l	k	AS	MT	MT 2	F <sub>a,z</sub>
Unit description	(mm) x (mm) x (mm)	(mm)	(mm)	(mm)	(mm)	(mm)	(mm)	(mm)	(N)
6617210	50 x 123 x 100	35	32	96	83	23.5x11	4	2	2850